

FLOOR SPRING & HYDRAULIC PATCH

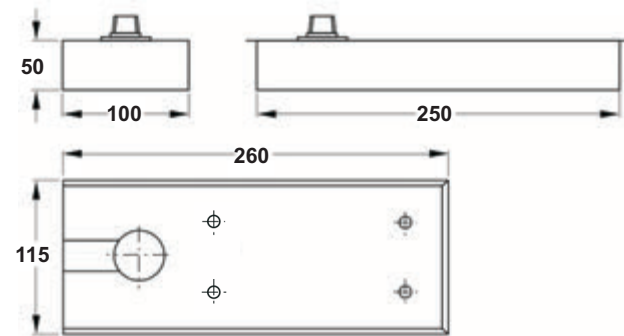

## GLASS DOOR FITTING - FLOOR SPRING



### Features:

- Maximum Door Weight : 90Kg.
- Maximum Door Width : 900mm
- Maximum Door Height : 2100mm.
- Hold Open (Standard) : 90° hold open
- Finish(Cover) : SSS

**NFS - 900 Single Cylinder Floor Spring for Wood /Aluminum / Glass Door**

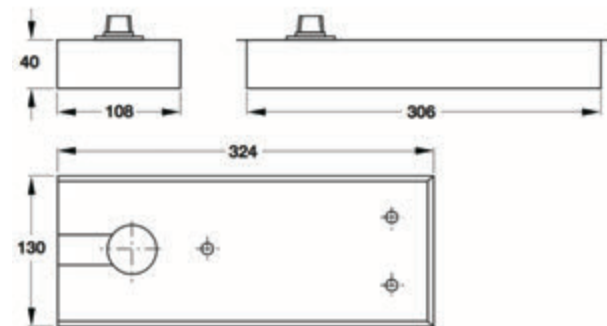

### Features:

- Maximum Door Weight : 120 Kg
- Maximum Door Width : 1050mm
- Maximum Door Height : 2400mm.
- Hold Open (Standard) : 90° hold open
- Finish(Cover) : SSS

**NFS - 1200 Double Cylinder Floor Spring for Wood / Aluminum / Glass Door**

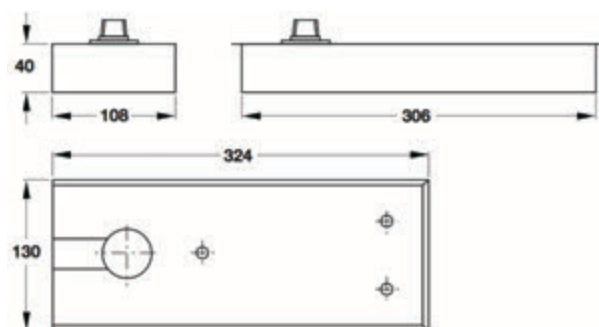

### Features:

- Maximum Door Weight : 150 Kg
- Maximum Door Width : 1200mm
- Maximum Door Height : 2600mm.
- Hold Open (Standard) : 90° hold open
- Finish(Cover) : SSS

**NFS - 1500 Double Cylinder Floor Spring for Wood / Aluminum / Glass Door**

**GLASS DOOR FITTING - PATCH FITTING**

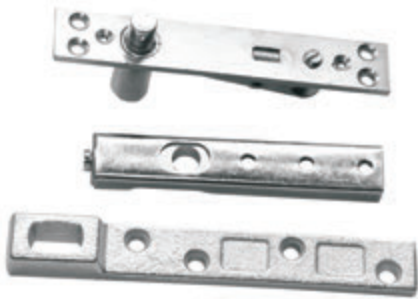

**Features:**

- Supplied with Top and Bottom Strap

**NFS - ACC - 01  
Top & Bottom Pivot for Wooden / Aluminum Door**

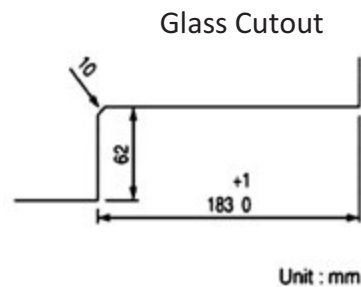

**Features:**

- Floor hinge for double action swing door. Installation in the floor
- Hold Open Angle : 90°.
- Suitable Glass Thickness : 8mm / 10mm / 12mm.
- Maximum Door Width : 900mm
- Maximum Door Height : 2100mm.
- Maximum Door Weight : 90kgs.
- Finish : Satin Stainless Steel.

**NHP - 700  
Hydraulic Patch for Glass Door**

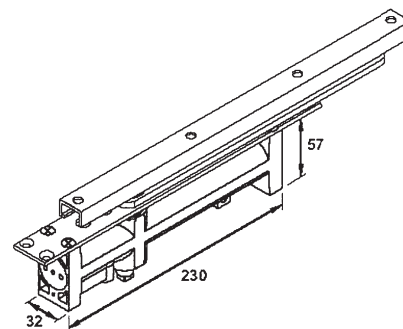

**Features:**

- With slide rail.
- Mounting height only 57 mm.
- Maximum Door Weight - 60 kgs.
- Maximum Door Width - 950 mm.
- Maximum angle of door opening - 120°.
- Finish - Silver

**NCDC - 01  
Concealed Door Closer**

PATCH FITTING



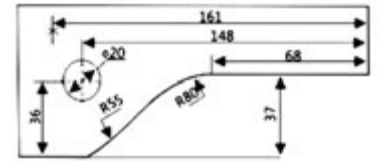
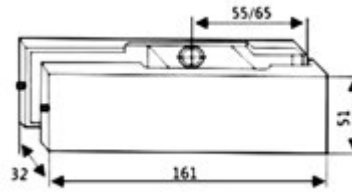

Glass Preparation

**Features:**

- With SS 304 cover
- Base Material Casting :- Aluminium alloy
- Suitable Glass thickness 10mm / 12mm.
- Finish :- SSS / PSS

**NPF - 901 Top Patch**

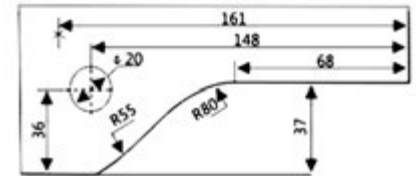
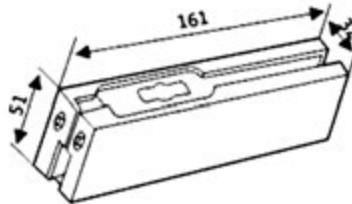

Glass Preparation

**Features:**

- With SS 304 cover
- Base Material Casting :- Aluminium Alloy
- Suitable Glass thickness 10mm / 12mm.
- Finish :- SSS / PSS

**NPF - 902 Bottom Patch**

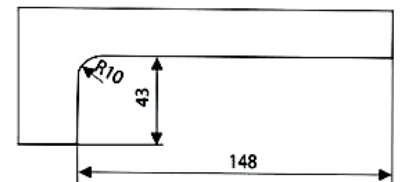
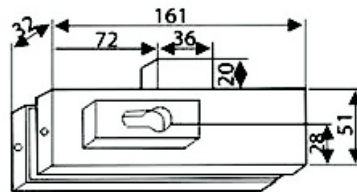

Glass Preparation

**Features:**

- With SS 304 cover
- Base Material Casting :- Aluminium Alloy
- Suitable Glass thickness 10mm / 12mm.
- Finish :- SSS / PSS

**NPF - 903 Bottom Patch Lock**



**GLASS DOOR FITTING - PATCH FITTING**

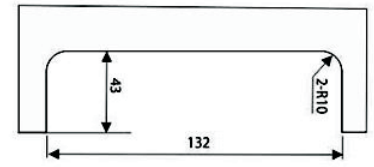
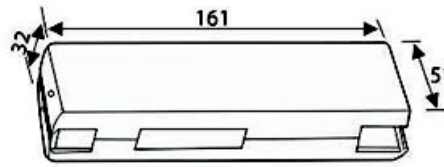

Glass Preparation

**Features:**

- With SS 304 cover
- Base Material Casting :- Aluminium Alloy
- Suitable Glass thickness 10mm / 12mm
- Finish :- SSS / PSS

**NPF - 904 Strike Box For NPF - 903**

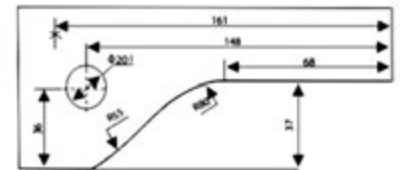
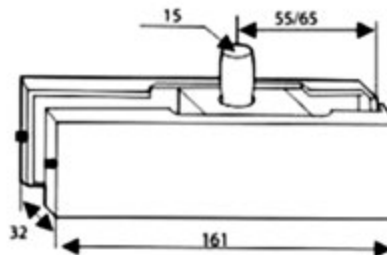

Glass Preparation

**Features:**

- With SS 304 cover
- Base Material Casting :- Aluminium Alloy
- Suitable Glass thickness 10mm / 12mm
- Finish :- SSS / PSS

**NPF - 905 Over Panel Patch with Pivot**

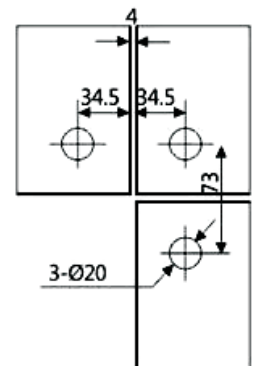
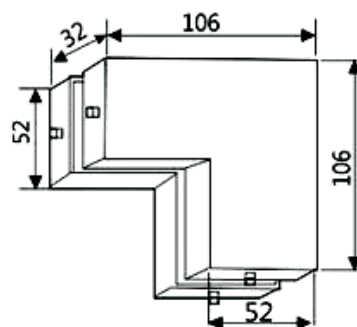
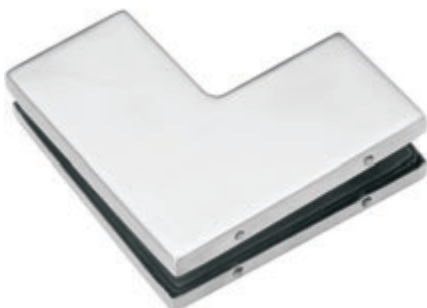

Glass Preparation

**Features:**

- With SS 304 cover
- Base Material Casting :- Aluminium Alloy
- Suitable Glass thickness 10mm / 12mm
- Finish :- SSS / PSS

**NPF - 906 Small "L" Patch**

**GLASS DOOR FITTING - PATCH FITTING**

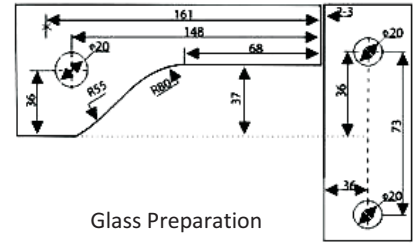
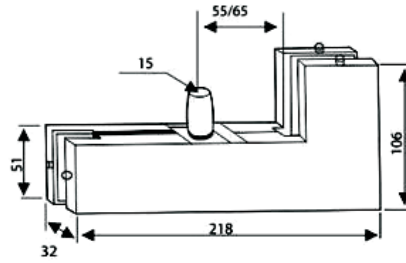

**Features:**

- With SS 304 cover
- Base Material Casting :- Aluminium Alloy
- Suitable Glass thickness 10mm / 12mm
- Finish :- SSS / PSS

**NPF - 907 Big "L" Patch with Pivot**

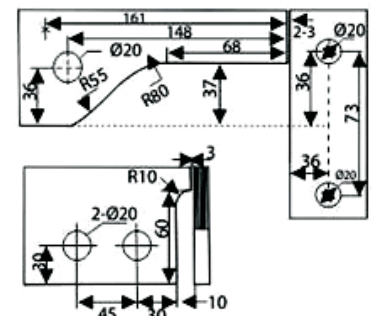
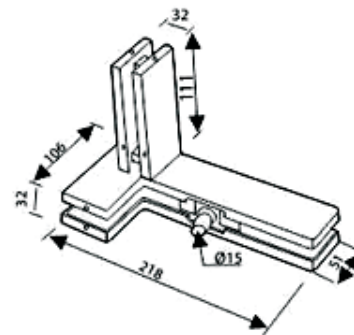

**Features:**

- Left handed Fin
- Handing policy to be determined by looking from inside of the structure
- With SS 304 cover
- Base Material Casting :- Aluminium Alloy
- Suitable Glass thickness 10mm / 12mm
- Finish :- SSS / PSS

**NPF - 908 L Big "L" Patch with Pivot & Fin - Left**

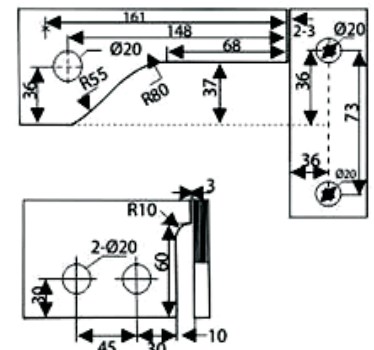
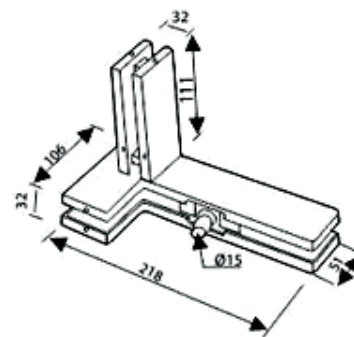

**Features:**

- Right handed Fin.
- Handing policy to be determined by looking from inside of the structure.
- With SS 304 cover.
- Base Material Casting :- Aluminium Alloy.
- Suitable Glass thickness 10mm / 12mm.
- Finish :- SSS / PSS

**NPF - 908 R Big "L" Patch with Pivot & Fin - Right**

**GLASS DOOR FITTING - PATCH FITTING**

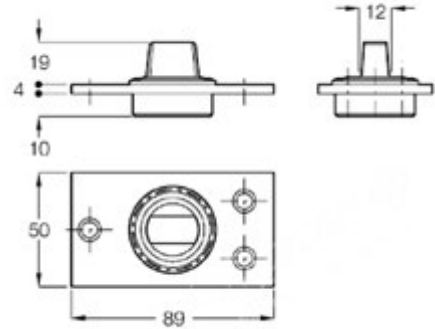

**Features:**

- Material :- SS - 304
- Finish :- SSS

**NPF - 909 Bottom Pivot**



**Features:**

- Pivot held in overhead structure
- Material :- S.S. 304
- Finish :- SSS

**NPF - 910 Top Pivot**

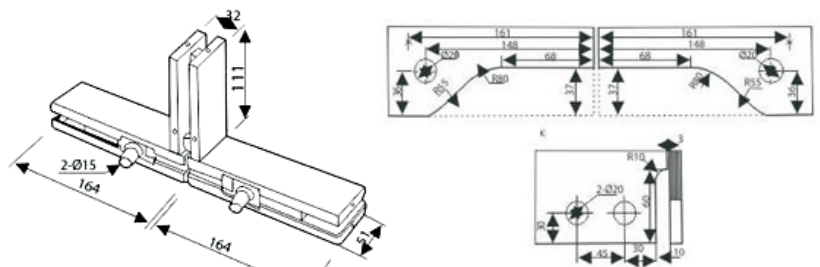

Glass Preparation

**Features:**

- Connecting fin with the over panel.
- With S.S. 304 cover
- Base Material Casting :- Aluminum Alloy
- Finish :- SSS

**NPF - 911 Over Panel Patch with Fin for Back to Back Doors**



**GLASS DOOR FITTING - PATCH FITTING**

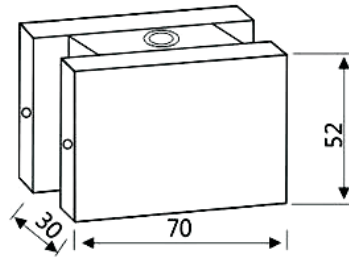

Side connector

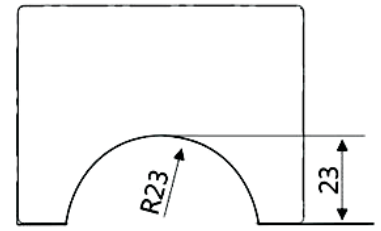

Glass Preparation

**Features:**

- With S.S. 304 cover
- Base Material Casting:-Aluminium Alloy
- Suitable Glass thickness 10mm / 12mm.
- Finish: SSS / PSS

**NPF - 912 Single Glass Connector Patch**

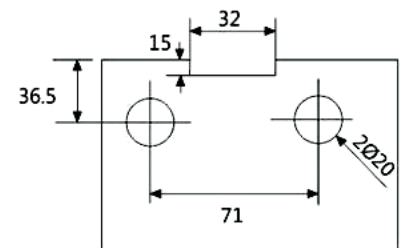
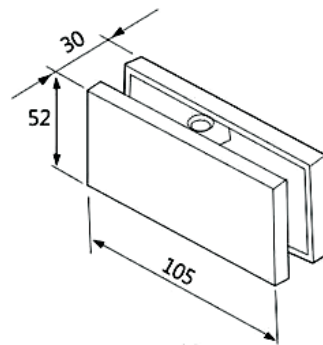

Glass Preparation

**Features:**

- With S.S. 304 cover
- Base Material Casting:-Aluminium Alloy
- Suitable Glass thickness 10mm / 12mm.
- Finish: SSS / PSS

**NPF - 913 Glass to Glass Connector Patch**

**GLASS DOOR FITTING**

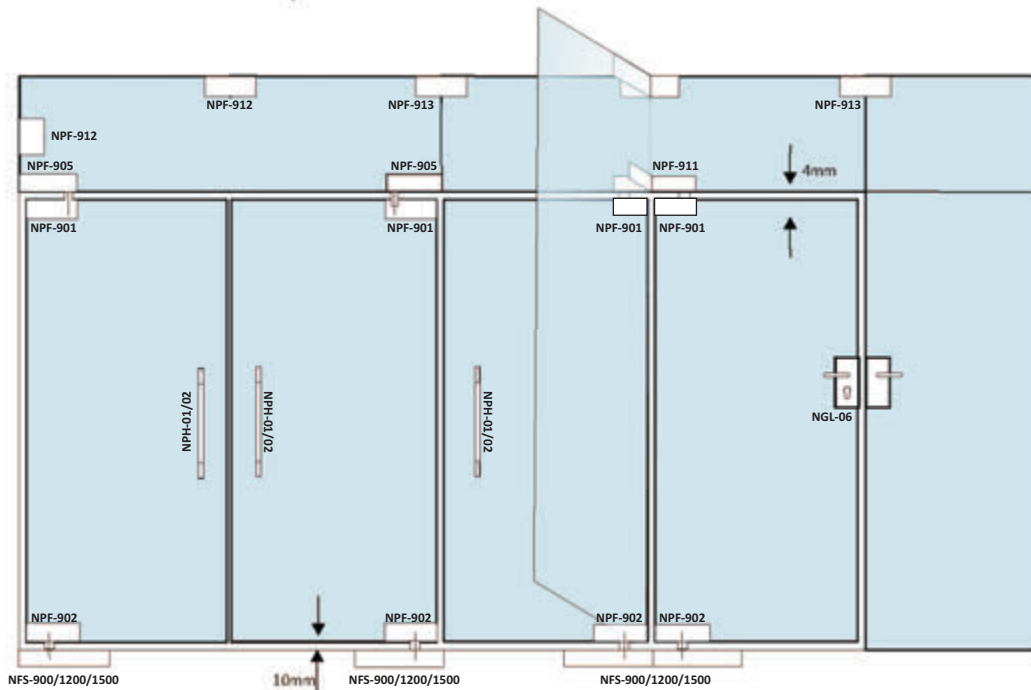
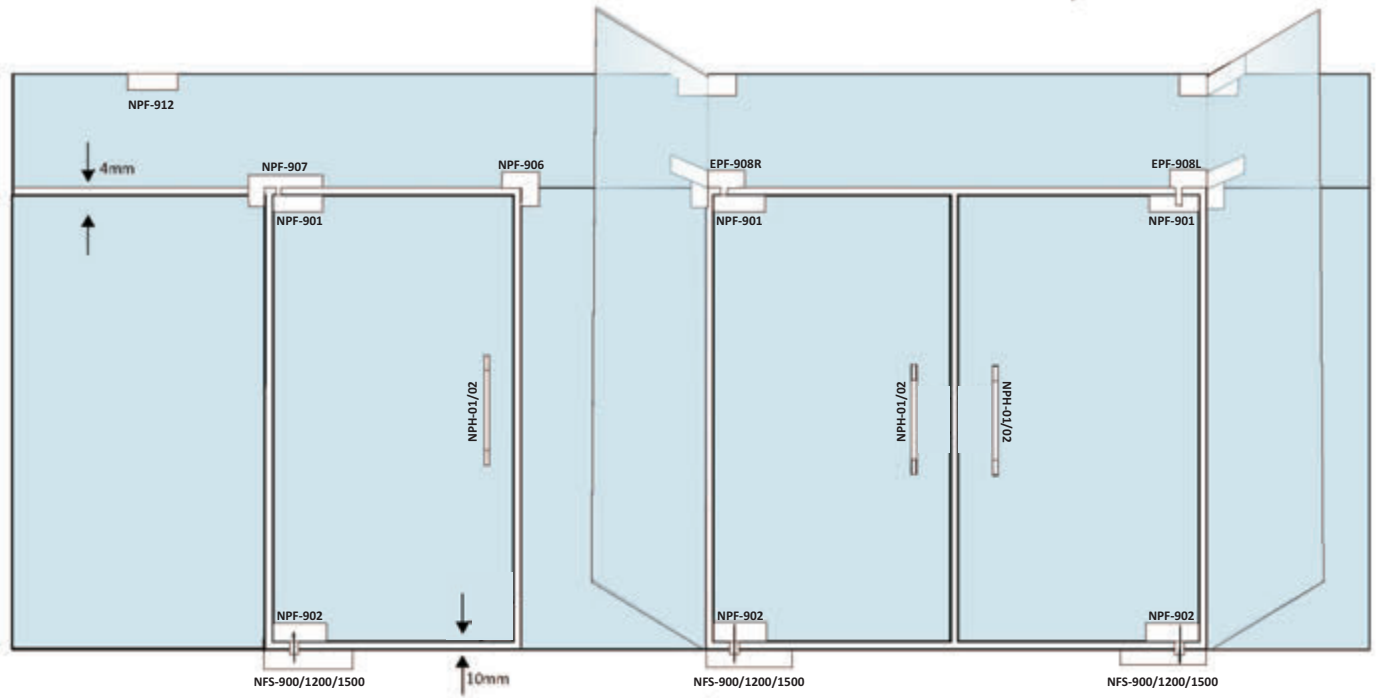
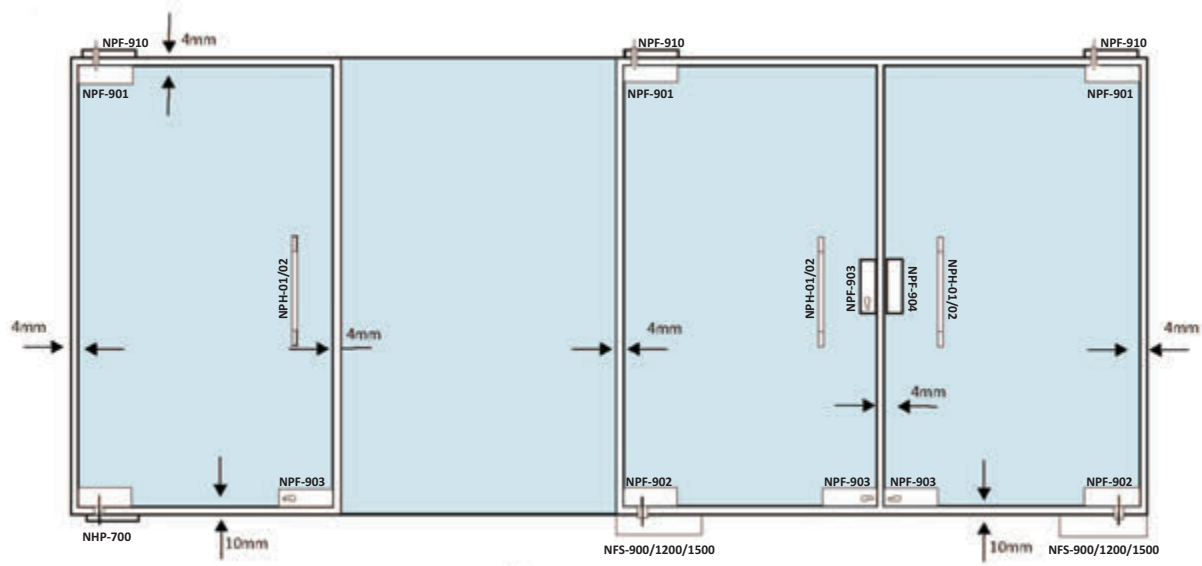

## Glass Architectural Hardware

The technical presentations and dimensions in the illustrations and drawings are non binding. We reserve the right to make changes to specifications at any time. We do not accept any responsibility for any errors which may occur in the production of this catalogue. All sizes in millimeter (mm).

The products in this list are the ones that are currently in the NSA product range. Since our product range is updated frequently, please feel free contact us if you cannot find any particular information.

The printed colours indicating the surface finishes are not 100% true, but do provide a useful guide.

Pictures may show designs which are different to the scope of delivery.



INNOVATION WITH INTEGRITY

**Marketed by :**

**N. S. Enterprises**

C-8, Room No. 4/5, Opp. Ram Mandir,  
Bhadran Nagar, S. V. Road,  
Malad (W), Mumbai - 400 064.

Tel. : +91 22 2807 6175

Email : ns\_enterprise@yahoo.co.in

Website: <https://nsaenterprise.com> | <https://www.indiamart.com/n-senterprisesmumbai/>